

x1

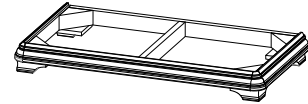

x1

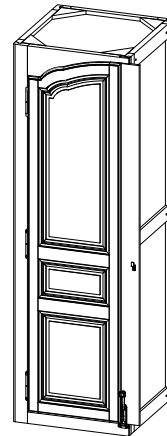

x1

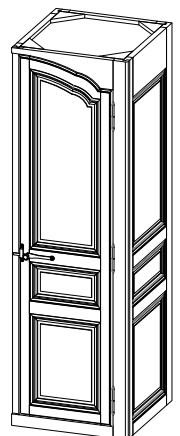

x1

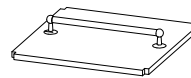

x1

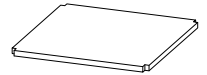

x5

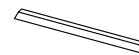

x12

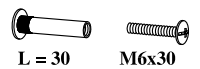

x6



x2



M4x15

x4

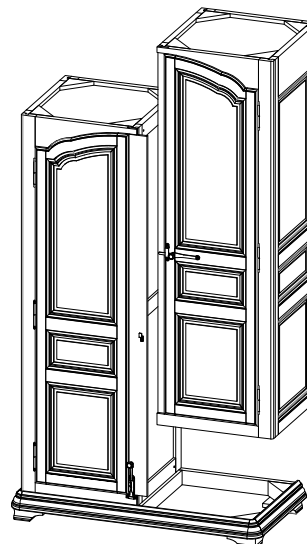
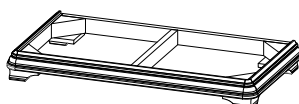
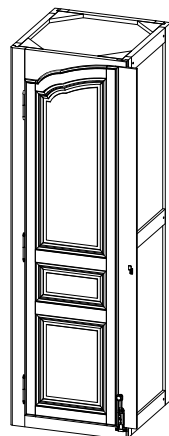

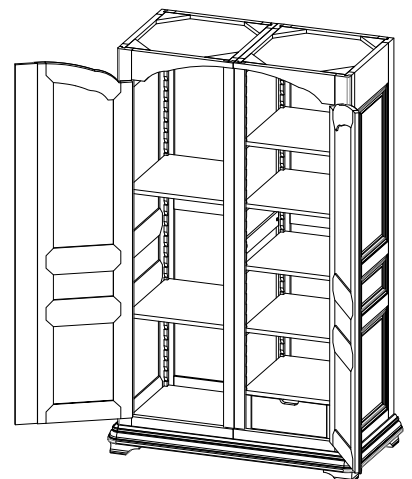
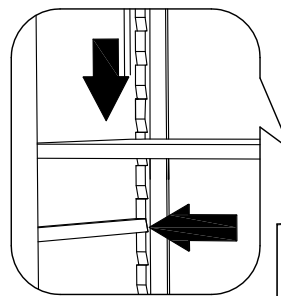
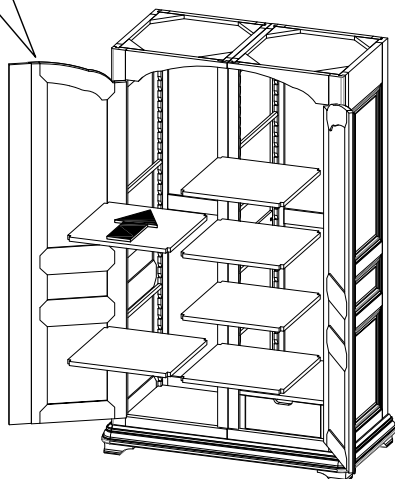
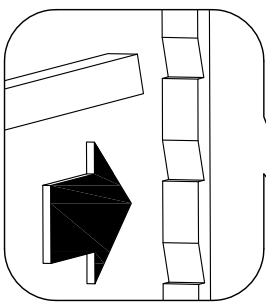
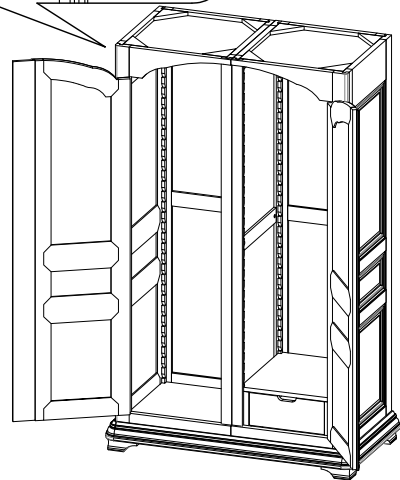
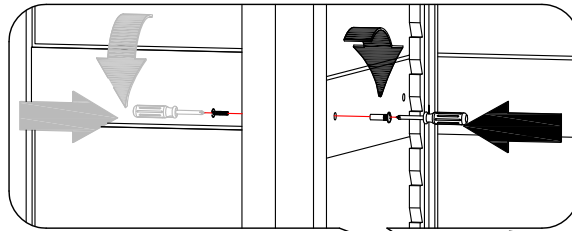
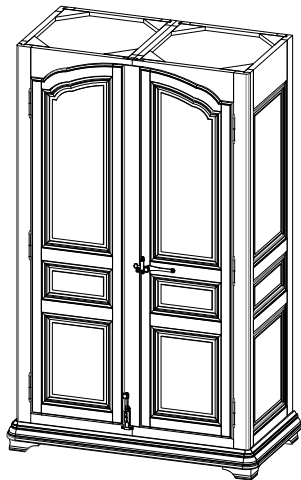

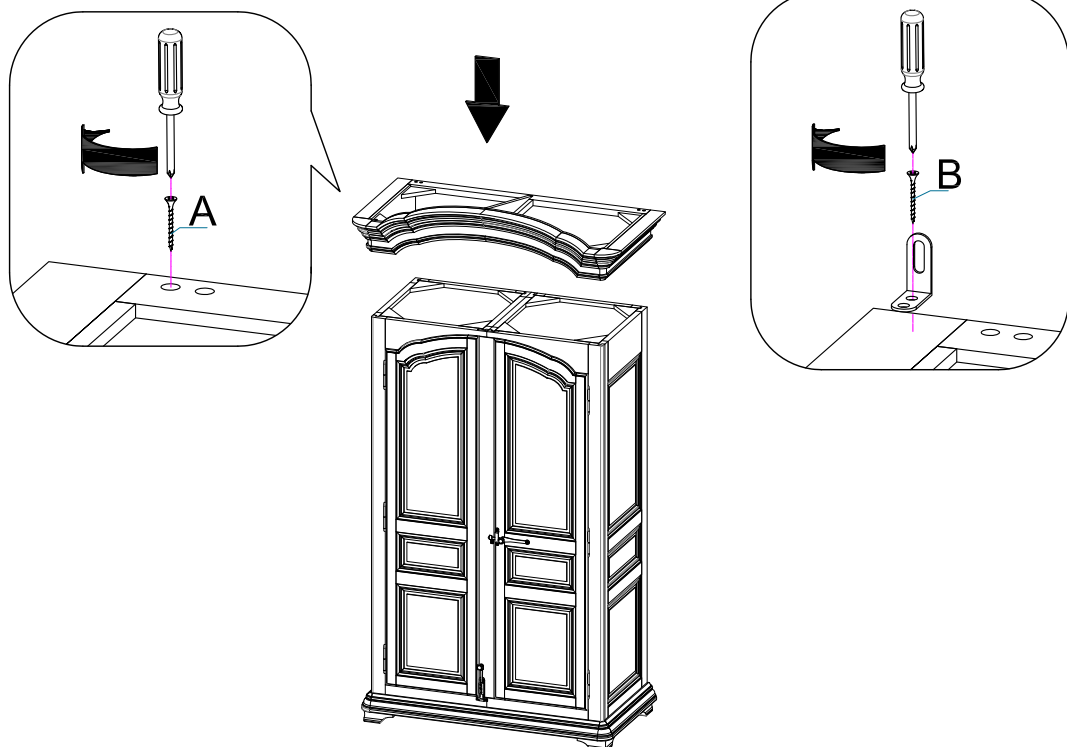
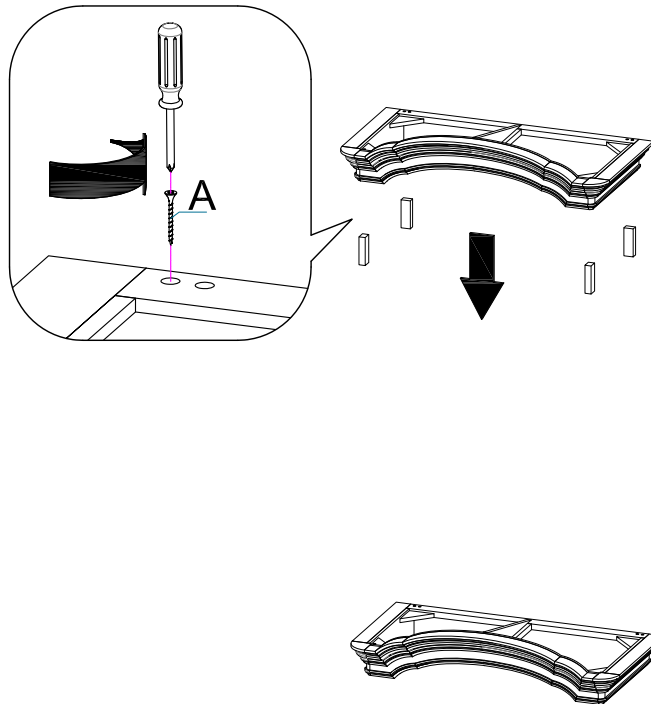

# GUIDE DE FIXATION MURALE

Si le matériau de votre cloison n'est pas répertorié ou si vous avez des questions, renseignez-vous auprès d'un magasin de bricolage.

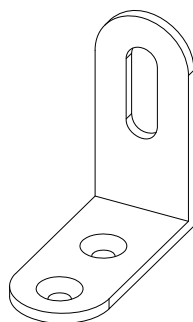

## MATÉRIAU DE LA CLOISON

Cloison en plâtre avec ossature bois accessible.



## DISPOSITIF DE FIXATION

Vis insérée directement dans l'ossature.

Par exemple,

une vis à bois de 5 mm de notre set de chevilles et vis FIXA.

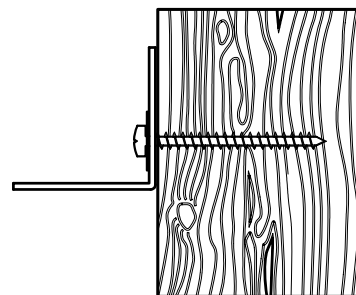

FIGURE 1



## MATÉRIAU DE LA CLOISON

Cloison en plâtre sans ossature bois accessible



## DISPOSITIF DE FIXATION

Vis avec cheville.

Par exemple,

une cheville de 8 mm de notre set de vis et chevilles FIXA.

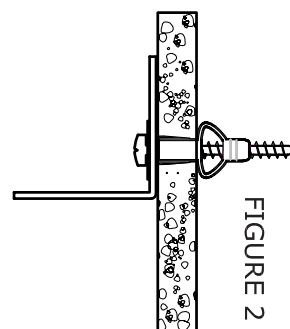

FIGURE 2



## MATÉRIAU DE LA CLOISON

Maçonnerie



## DISPOSITIF DE FIXATION

Mur plein : vis avec cheville.

Par exemple,

une cheville de 8 mm de notre set de vis et chevilles FIXA.

(figure 3A)

Mur creux : cheville à expansion.

(figure 3B)

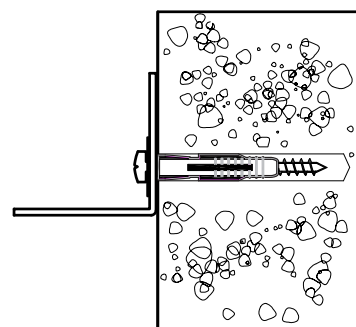

FIGURE 3A

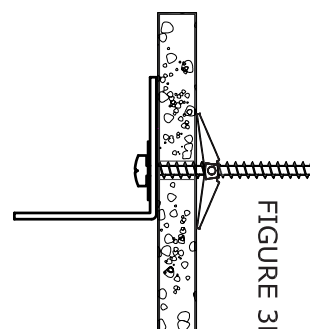

FIGURE 3B